

From wet, sticky clay...

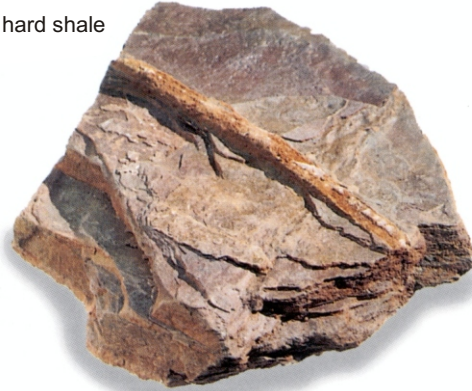

...to hard shale



**Process a
greater variety
of materials
with the STEELE
Disintegrator.**

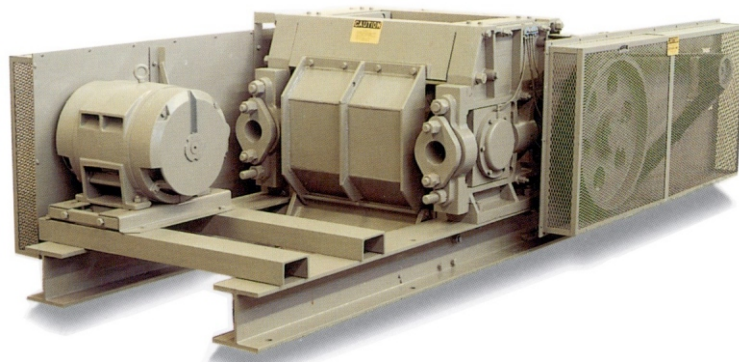

J.C. STEELE AND SONS, INC. • *The Best in Clay Machinery Since 1889*

Versatility makes the **STEELE** Disintegrator an exceptionally useful material crusher with a consistently sized output.

No other piece of equipment does a better job of reducing wet clays - but that's just part of the story. The Steele Disintegrator can be fed a steady diet of shale, filter cakes, limestone and other medium-hard rocks right along with wet and sticky clays. Even with this wide range in feed materials, output is predictable and consistent.

If fine grinding is not required, the Disintegrator can be the only machine needed in the production process:

CLAY - Even wet and sticky clays, in any feedable lump size, will be reduced into small chips no thicker than 6mm (1/4").

SHALE, SOFTER LIMESTONES, FIRECLAY - Along with other dry materials - up to 60% of the discharge will be screenable through No. 8 mesh. Crushing is most effective when the ratio of feed material size to output size is 8 to 1 or less.

Intermediate Crushing

For fine grinding operations, the Disintegrator is ideal as an intermediate crusher between the primary crusher and the final crusher (typically a dry pan or hammermill). Final grinding times can be reduced as much as 50%.

Preparation for smooth roll crushing

The 6mm (1/4") thick chips produced by the Disintegrator are perfect for smooth roll crushing. Also, flat cakes or plates output by a smooth roll crusher can be recirculated through a Disintegrator and broken up.

Attention-to-detail design, rugged, built-to-last construction, material and process versatility - the Steele Disintegrator is the most cost effective answer to a wide range of material preparation problems.

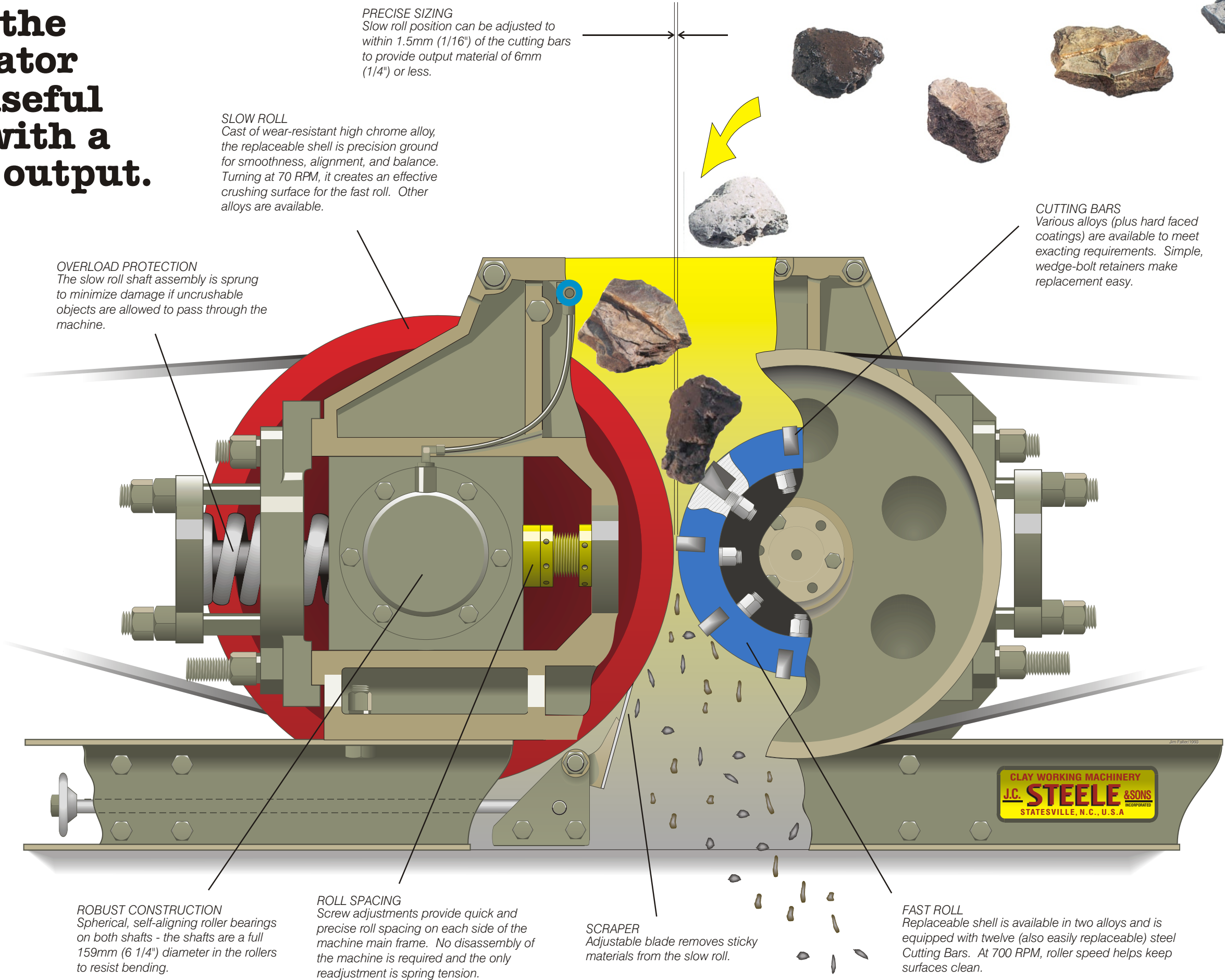

PRECISE SIZING
Slow roll position can be adjusted to within 1.5mm (1/16") of the cutting bars to provide output material of 6mm (1/4") or less.

SLOW ROLL
Cast of wear-resistant high chrome alloy, the replaceable shell is precision ground for smoothness, alignment, and balance. Turning at 70 RPM, it creates an effective crushing surface for the fast roll. Other alloys are available.

OVERLOAD PROTECTION
The slow roll shaft assembly is sprung to minimize damage if uncrushable objects are allowed to pass through the machine.

CUTTING BARS
Various alloys (plus hard faced coatings) are available to meet exacting requirements. Simple, wedge-bolt retainers make replacement easy.

ROBUST CONSTRUCTION
Spherical, self-aligning roller bearings on both shafts - the shafts are a full 159mm (6 1/4") diameter in the rollers to resist bending.

ROLL SPACING
Screw adjustments provide quick and precise roll spacing on each side of the machine main frame. No disassembly of the machine is required and the only readjustment is spring tension.

SCRAPER
Adjustable blade removes sticky materials from the slow roll.

FAST ROLL
Replaceable shell is available in two alloys and is equipped with twelve (also easily replaceable) steel Cutting Bars. At 700 RPM, roller speed helps keep surfaces clean.

GENERAL SPECIFICATIONS

6B Series DISINTEGRATORS

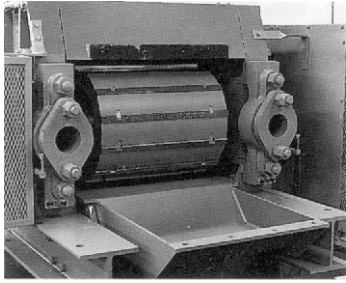

Fast Roll 457mm (18") OD

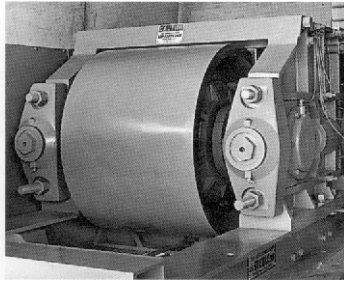

Slow Roll 813mm (32") OD

CAPACITY

6B-24 610mm (24") wide rollers

Fast Roll Motor

37 kW (50 HP)
45 kW (60 HP)
56 kW (75 HP)

Throughput

55-65 Metric Tons/Hr (60-70 US Tons/Hr)
65-75 Metric Tons/Hr (70-80 US Tons/Hr)
75-90 Metric Tons/Hr (80-100 US Tons/Hr)

6B-18 457mm (18") wide rollers

30 kW (40 HP)
37 kW (50 HP)
45 kW (60 HP)

35-45 Metric Tons/Hr (40-50 US Tons/Hr)
45-55 Metric Tons/Hr (50-60 US Tons/Hr)
55-65 Metric Tons/Hr (60-70 US Tons/Hr)

NOTE:

Capacity figures assume minimum spacing between rolls for output of particles 12mm (1/2") width maximum.

Throughput values can vary greatly depending on material.

For clay, lumps should be no larger than 150mm (6") across with maximum lump size limited by the hopper dimensions.

For harder input material, the ratio of feed material size to output particle size should be 8 to 1 or less.

A metal detector is required in the feeding system to prevent metals from being introduced into the machine.

WEIGHT

6B-18
4,535 Kg (10,000 Lbs)

6B-24
5,670 Kg (12,500 Lbs)

DIMENSIONS

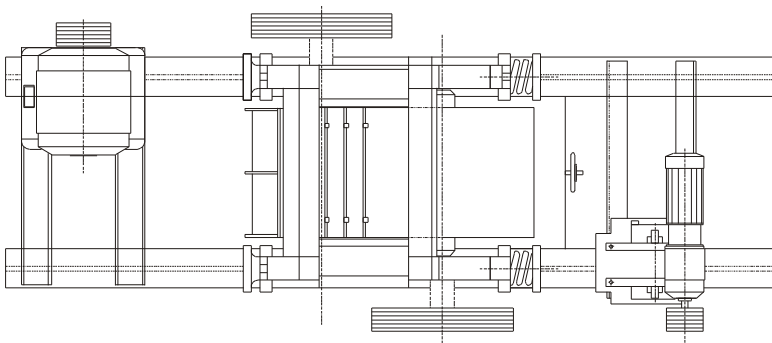

6B-18 and 6B-24 Disintegrator - Top View

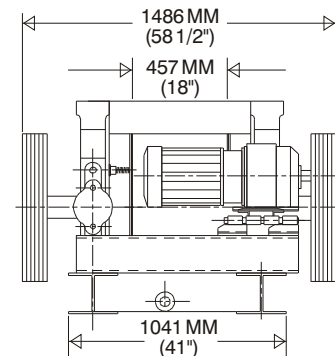

6B-18 Disintegrator - End View

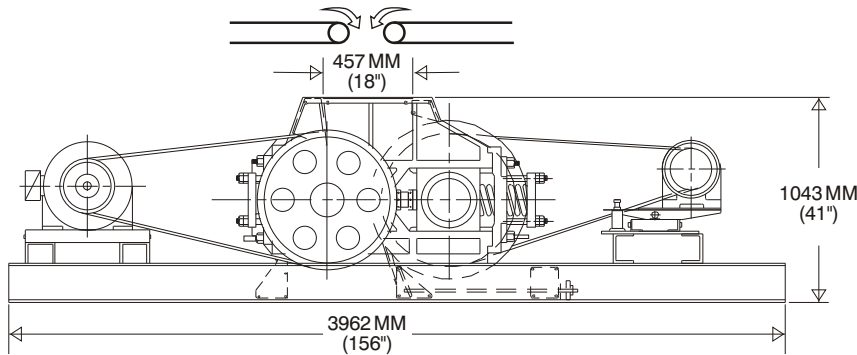

6B-18 and 6B-24 Disintegrator - Top View

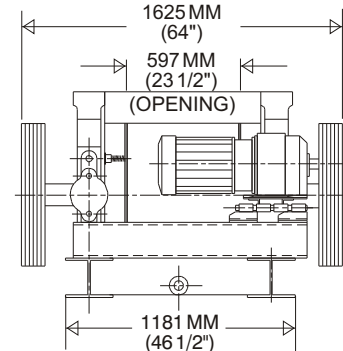

6B-24 Disintegrator - End View

Visit us on the web. View or download Sales Literature, sign up for SteeleService and more:

 www.jcsteele.com

The Best in Clay Machinery Since 1889

J.C. STEELE & SONS, INC.

P.O. Box 1834 • Statesville, NC USA 28687

TEL: (704) 872-3681

FAX: (704) 878-0789

**Call Toll Free (US only):
1-800-278-3353**

